

ITEM NO.	PartNo	Description	QTY.
1	Reference	Jaguar S Type Passenger Seat	1
2	PCS001	Frame Assembly	1
3	2337T38	5 in rubber wheel w 1.5 in hub and .375 bearing	4
4		FW 3/8 SAE 18-8 SS	16
5		HN 3/8-16, 18-8 SS	4
6		HHCS 3/8-16 X 3 3/4, 316 SS	4
7		HHCS 3/8-16 X 1 1/2, 316 SS	2
8		HHCS 3/8-16 X 2 1/2, 316 SS	2

REVISIONS				
ZONE	REV.	DESCRIPTION	DATE	APPROVED
	-	Initial Release	1/23/2015	DH

HighlandWolf

www.highlandwolf.com

Dwg. No. **PCS000**

Sheet: **1** of **2**

Printed: 1/26/2015 10:38:26 PM

PC Game Seat

Drawn By: Dana H.

NOTICE TO ALL PERSONS RECEIVING THIS DRAWING
 This drawing is conditionally issued, and neither receipt nor possession thereof confers or transfers any right in, or license to the subject matter of the drawing, design, or the technical information shown thereon.

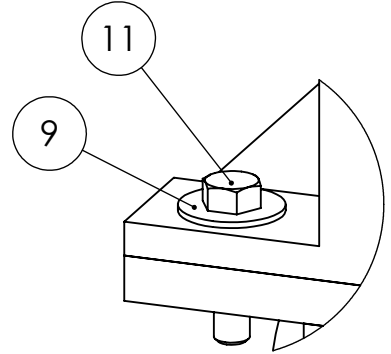

DETAIL B

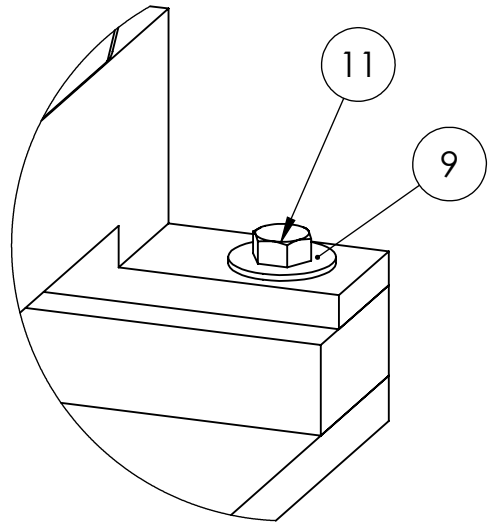

DETAIL A

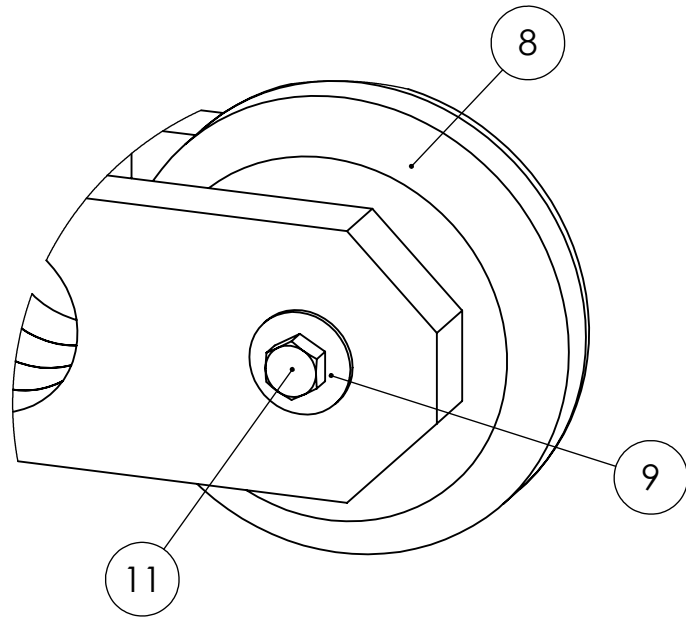

DETAIL C

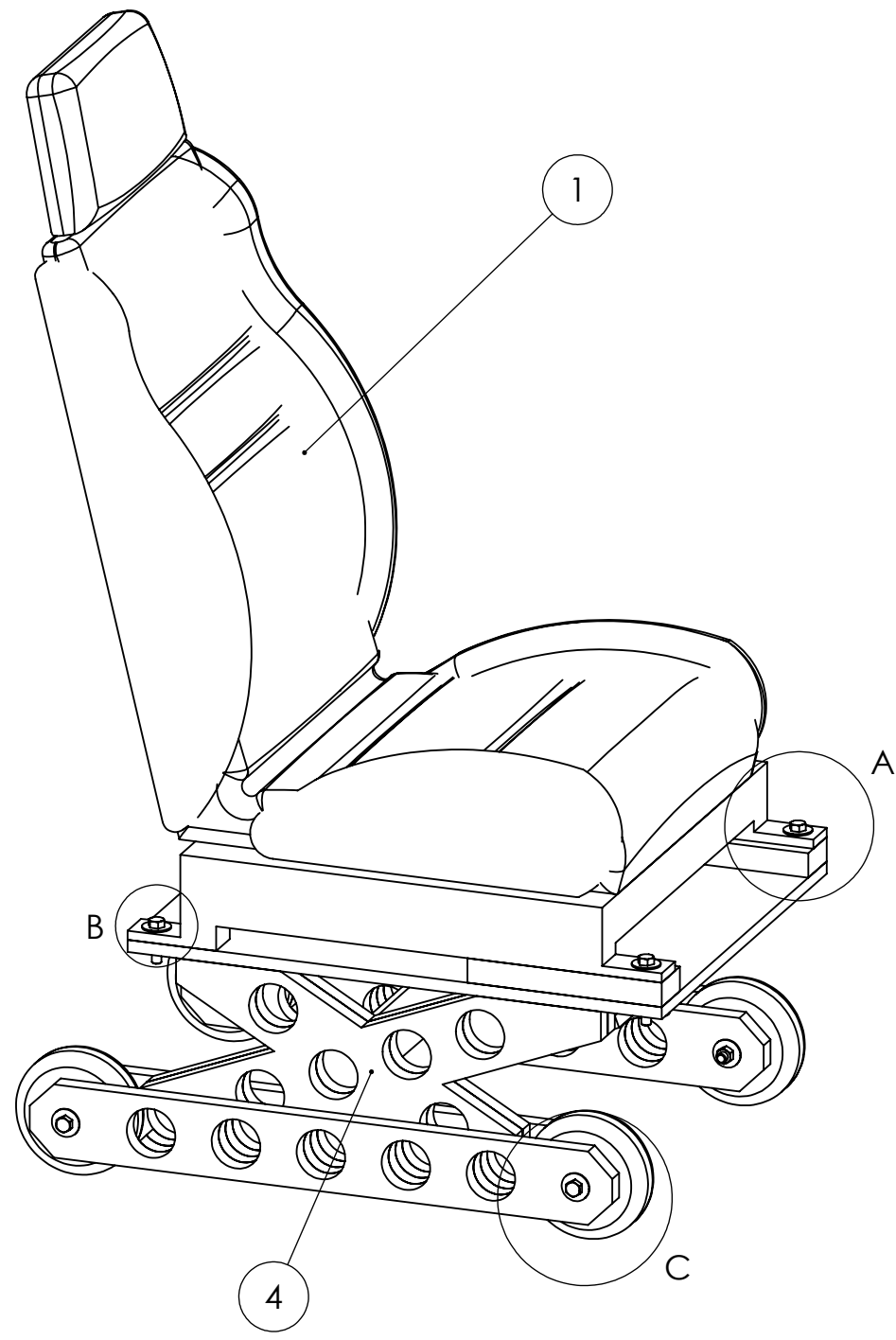

ALL DIMENSIONS ARE IN INCHES
 UNLESS OTHERWISE NOTED

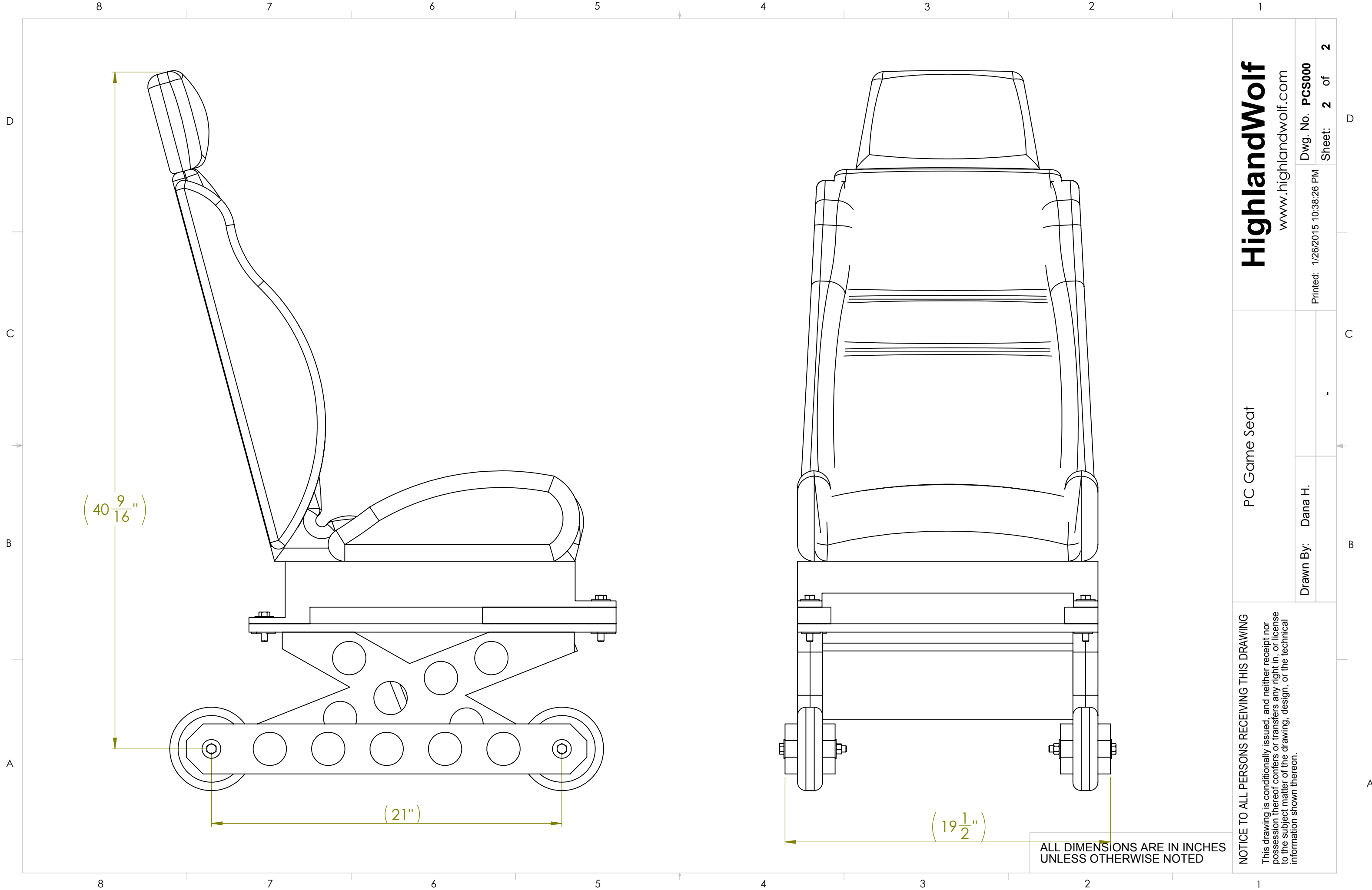

ALL DIMENSIONS ARE IN INCHES
UNLESS OTHERWISE NOTED

NOTICE TO ALL PERSONS RECEIVING THIS DRAWING
This drawing is conditionally issued, and neither receipt nor possession thereof confers or transfers any right in, or license to the subject matter of the drawing, design, or the technical information shown thereon.

PC Game Seat

HighlandWolf
www.highlandwolf.com

Drawn By: Dana H.

Printed: 1/26/2015 10:38:26 PM

Dwg. No. **PCS000**

Sheet: **2** of **2**

A

B

C

D

ITEM NO.	PartNo	Description	QTY.
1	PCS002	Base Plate	1
2	PCS003	Wheel Beam	4
3	PCS004	Cross Support	4
4	PCS005	Cross Plate	1
5	PCS006	Cross Plate Lip	1
6	PCS007	Standoff	2

REVISIONS				
ZONE	REV.	DESCRIPTION	DATE	APPROVED
	-	Initial Release	1/23/2015	DH

HighlandWolf
www.highlandwolf.com

Dwg. No. **PCS001**

Sheet: **1** of **2**

Printed: 1/26/2015 10:39:34 PM

Frame Assembly

Drawn By: Dana H.

NOTICE TO ALL PERSONS RECEIVING THIS DRAWING
This drawing is conditionally issued, and neither receipt nor possession thereof confers or transfers any right in, or license to the subject matter of the drawing, design, or the technical information shown thereon.

ALL DIMENSIONS ARE IN INCHES
UNLESS OTHERWISE NOTED

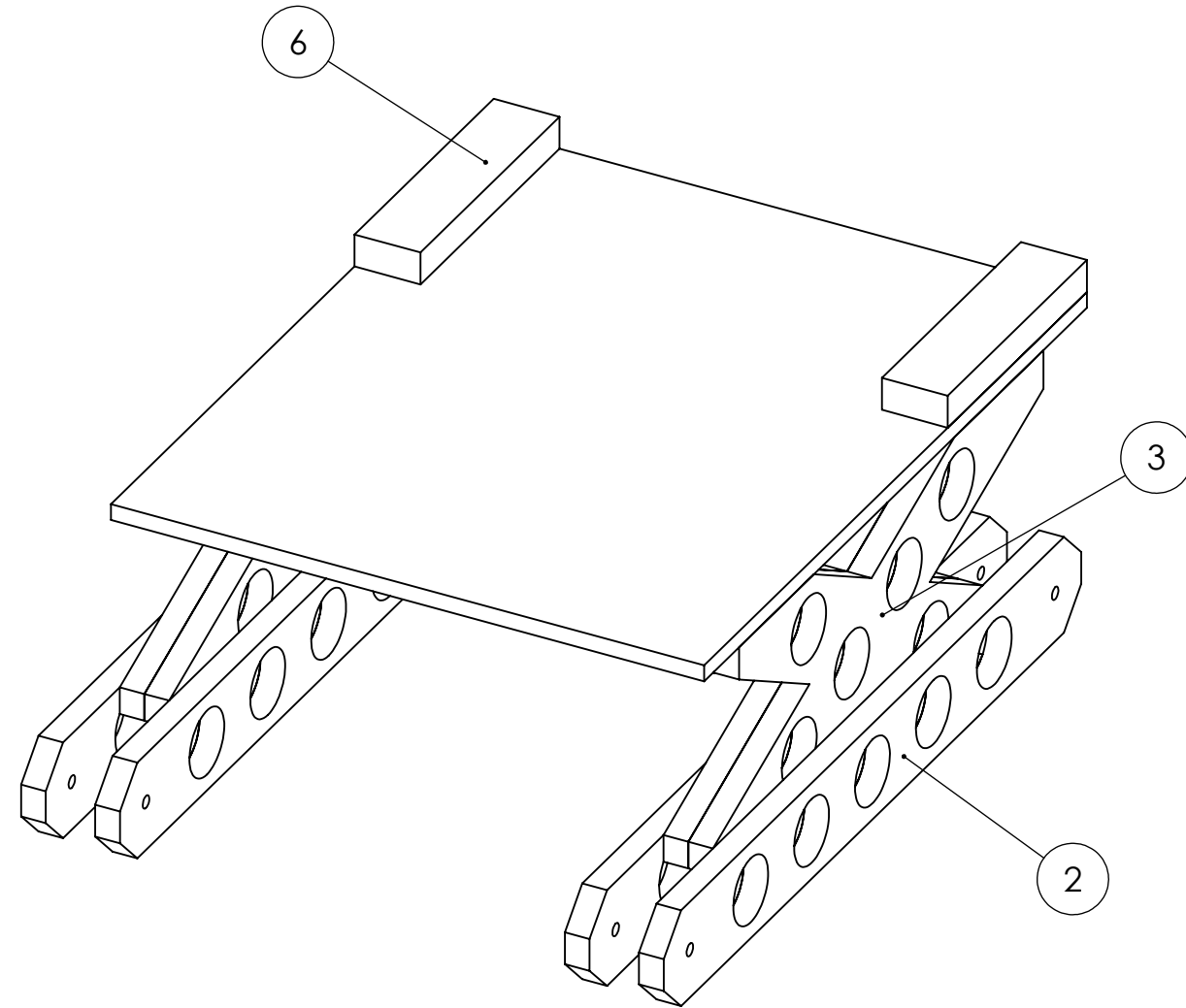
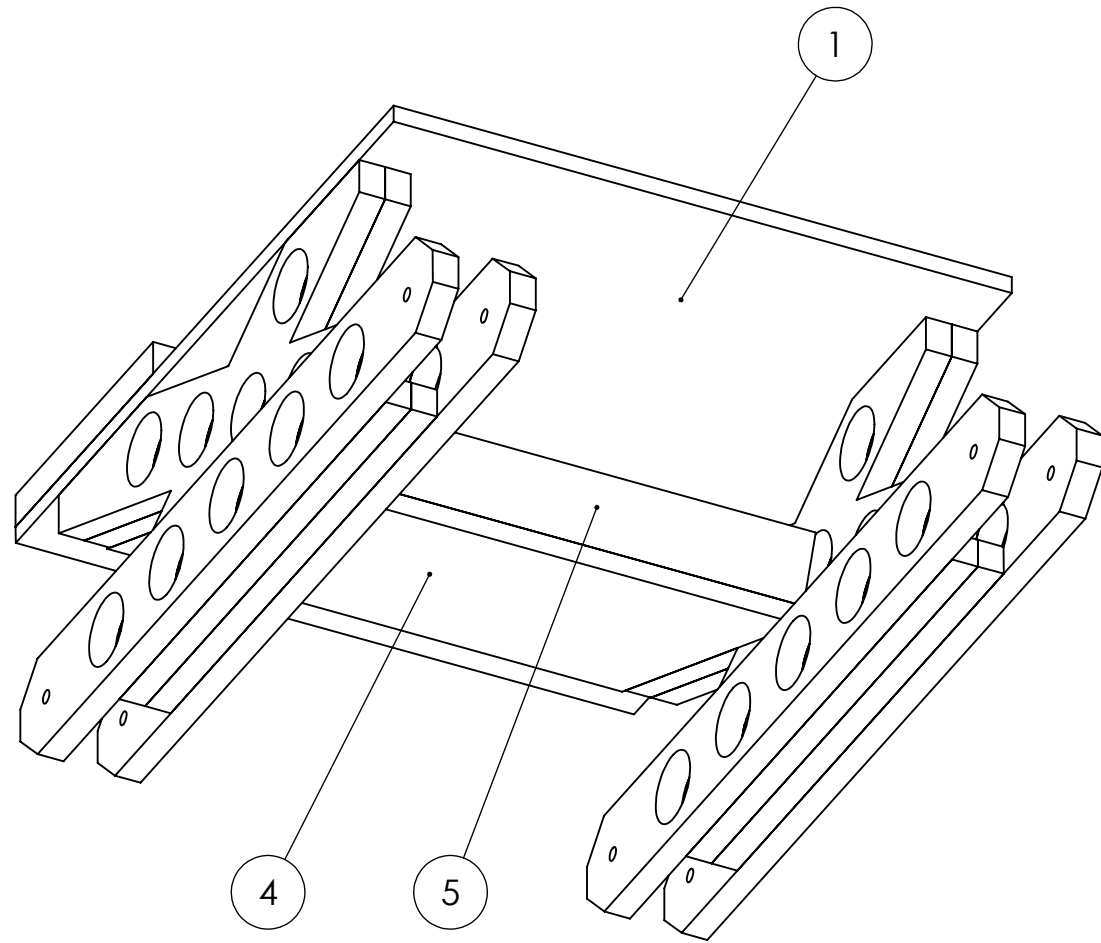

Notes:

1. Assemble with 1-1/4" wood screws and wood glue as needed
2. Painted with available red or grey gloss spray paint
3. 3/8" clearance holes for chair interface on PCS002 and PCS007 drilled to match seat structure

D

C

B

A

D

C

B

A

8

7

6

5

4

3

2

1

D

C

B

A

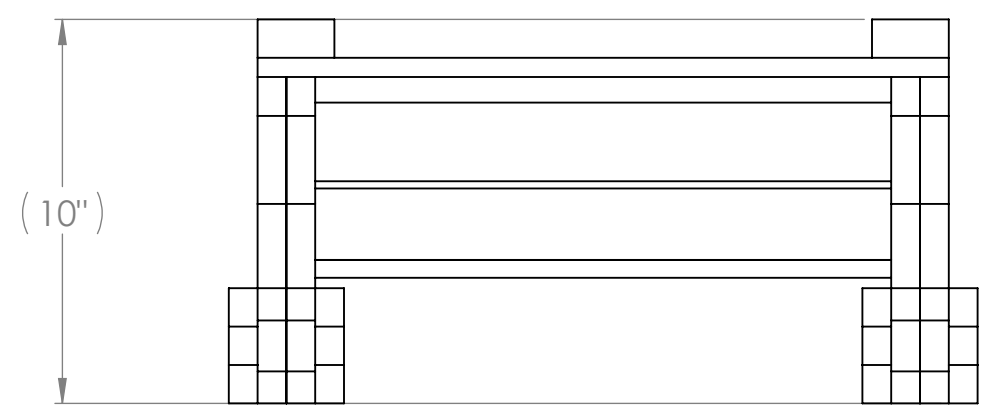
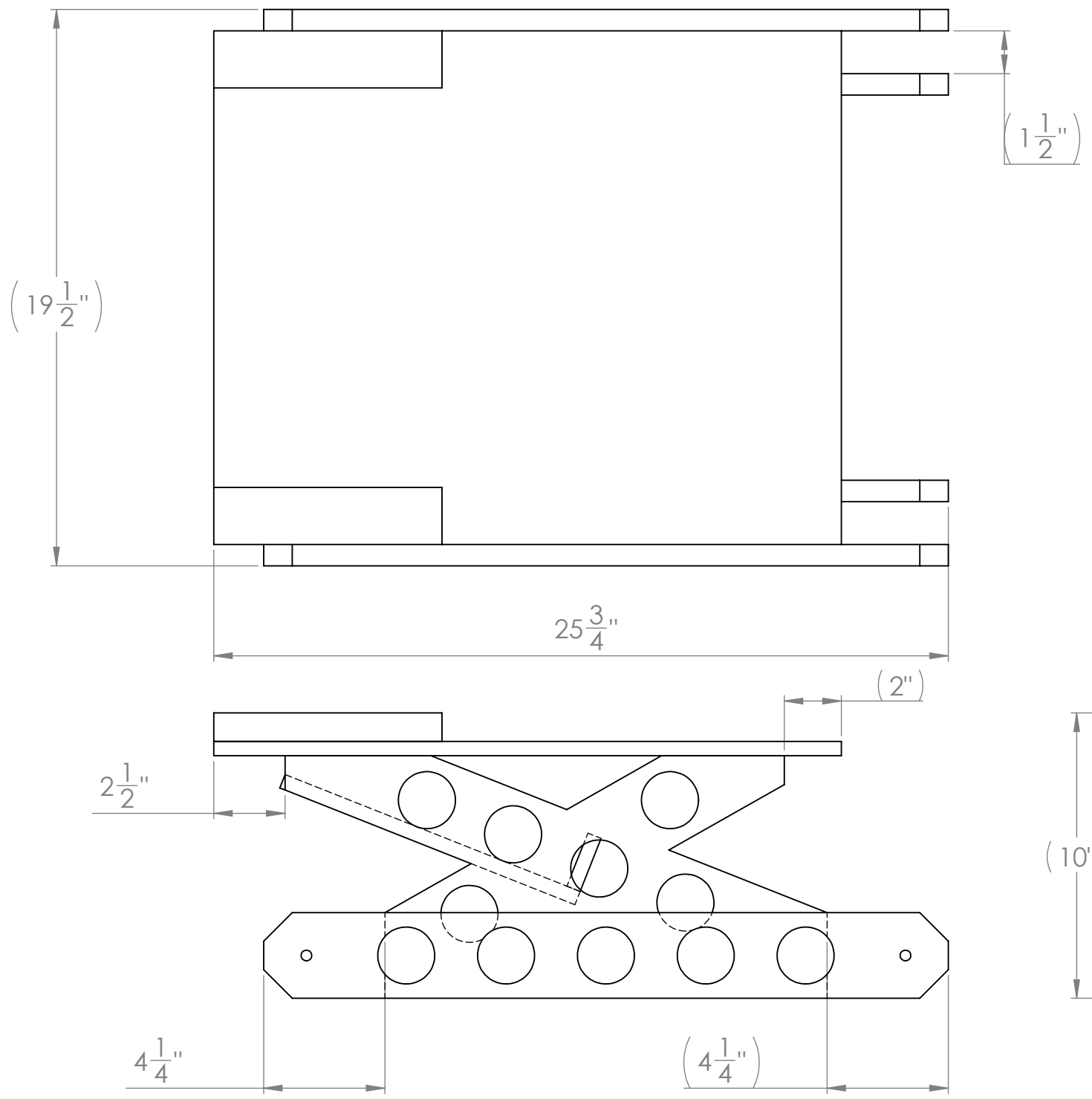

ALL DIMENSIONS ARE IN INCHES
UNLESS OTHERWISE NOTED

HighlandWolf

www.highlandwolf.com

Dwg. No. **PCS001**

Sheet: **2** of **2**

Printed: 1/26/2015 10:39:34 PM

Frame Assembly

Drawn By: Dana H.

NOTICE TO ALL PERSONS RECEIVING THIS DRAWING
This drawing is conditionally issued, and neither receipt nor possession thereof confers or transfers any right in, or license to the subject matter of the drawing, design, or the technical information shown thereon.

8

7

6

5

4

3

2

1

D

C

B

A

REVISIONS				
ZONE	REV.	DESCRIPTION	DATE	APPROVED
	-	Initial Release	1/23/2015	DH

Notes:
1. Make from 1/2" plywood

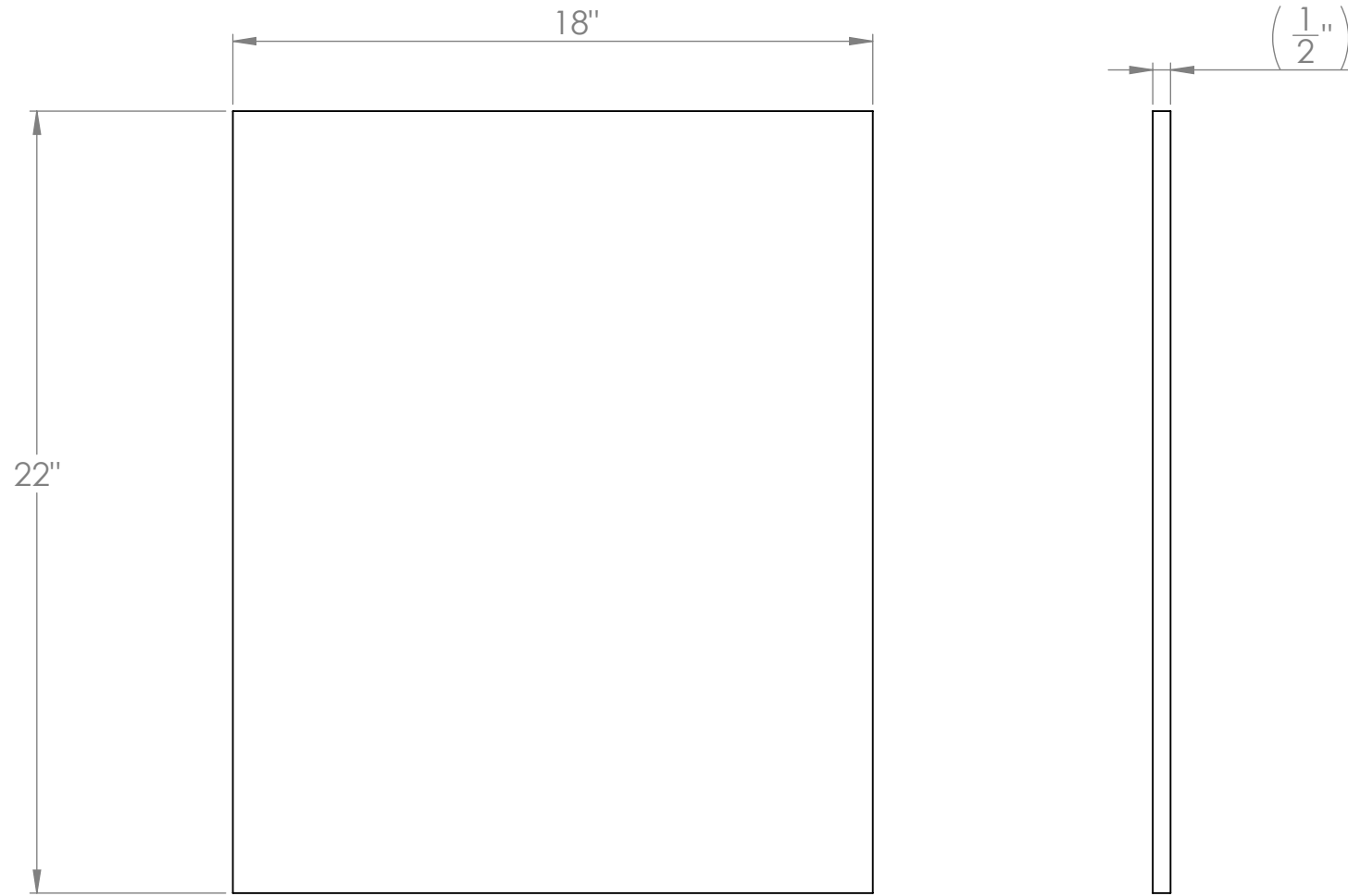

HighlandWolf
www.highlandwolf.com

Dwg. No. **PCS002**

Sheet: 1 of 1

Printed: 1/26/2015 10:40:14 PM

Base Plate

Drawn By: **Dana Howard**

INTERPRET PER ASME Y14.5-2009

TOLERANCES UNLESS OTHERWISE SPECIFIED:

X.X ± .1	FRACTIONAL:
X.XX ± .01	± 1/16
X.XXX ± .005	
∠ ± .5°	

ALL DIMENSIONS ARE IN INCHES UNLESS OTHERWISE NOTED

NOTICE TO ALL PERSONS RECEIVING THIS DRAWING
This drawing is conditionally issued, and neither receipt nor possession thereof confers or transfers any right in, or license to the subject matter of the drawing, design, or the technical information shown thereon.

8 7 6 5 4 3 2 1

REVISIONS

ZONE	REV.	DESCRIPTION	DATE	APPROVED
	-	Initial Release	1/23/2015	DH

- Notes:
 1. Make from 3/4" plywood.
 2. Drill 2" holes post assembly with PCS001

HighlandWolf
 www.highlandwolf.com

Dwg. No. **PCS003**
 Sheet: 1 of 1

Printed: 1/26/2015 10:40:54 PM

Wheel Beam

Drawn By: **Dana Howard**

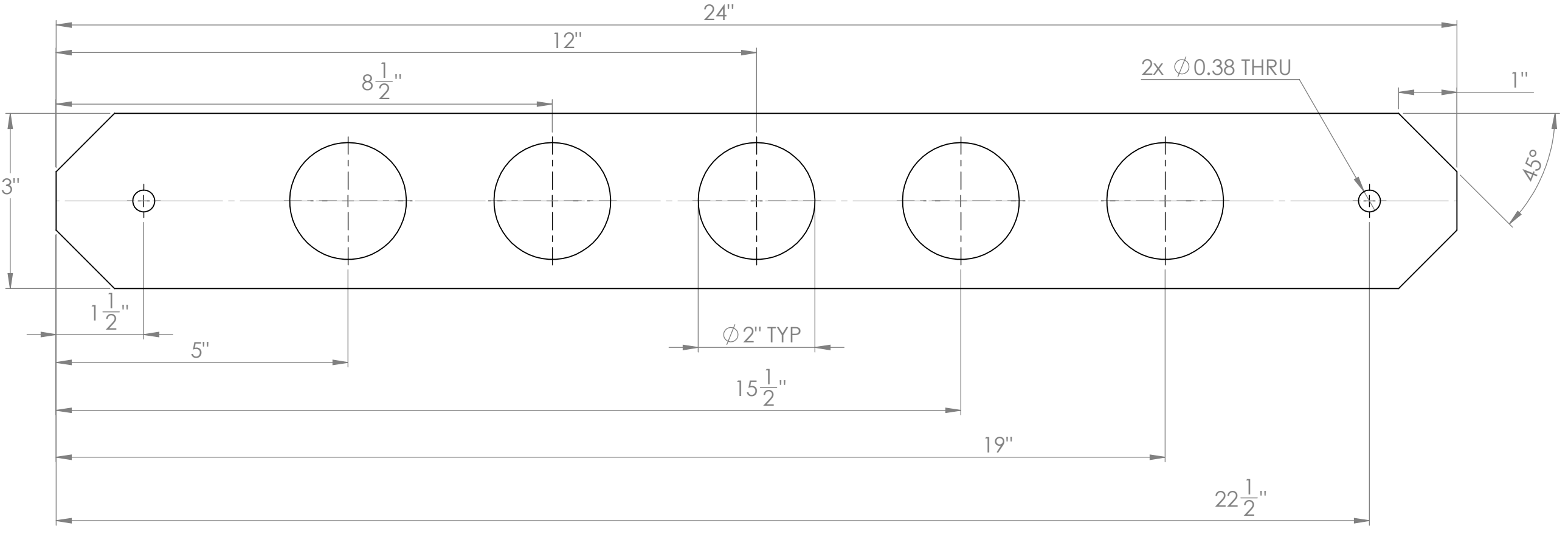

INTERPRET PER ASME Y14.5-2009

TOLERANCES UNLESS OTHERWISE SPECIFIED:
 X.X ± .1 FRACTIONAL:
 X.XX ± .01 ± 1/16
 X.XXX ± .005
 ∠ ± .5°

ALL DIMENSIONS ARE IN INCHES UNLESS OTHERWISE NOTED

NOTICE TO ALL PERSONS RECEIVING THIS DRAWING
 This drawing is conditionally issued, and neither receipt nor possession thereof confers or transfers any right in, or license to the subject matter of the drawing, design, or the technical information shown thereon.

8 7 6 5 4 3 2 1

Notes:

1. Manufacture from 3/4" Plywood
2. Drill match drill holes on all four PCS 004 parts, before assembly in PCS001

REVISIONS				
ZONE	REV.	DESCRIPTION	DATE	APPROVED

HighlandWolf
www.highlandwolf.com

Dwg. No. **PCS004**
Sheet: 1 of 1

Printed: 1/26/2015 10:41:42 PM

Cross Support

Drawn By: **Dana Howard**

NOTICE TO ALL PERSONS RECEIVING THIS DRAWING

This drawing is conditionally issued, and neither receipt nor possession thereof confers or transfers any right in, or license to the subject matter of the drawing, design, or the technical information shown thereon.

INTERPRET PER ASME Y14.5-2009	
TOLERANCES UNLESS OTHERWISE SPECIFIED:	
X.X ± .1	FRACTIONAL:
X.XX ± .01	± 1/16
X.XXX ± .005	
∠ ± .5°	
ALL DIMENSIONS ARE IN INCHES UNLESS OTHERWISE NOTED	

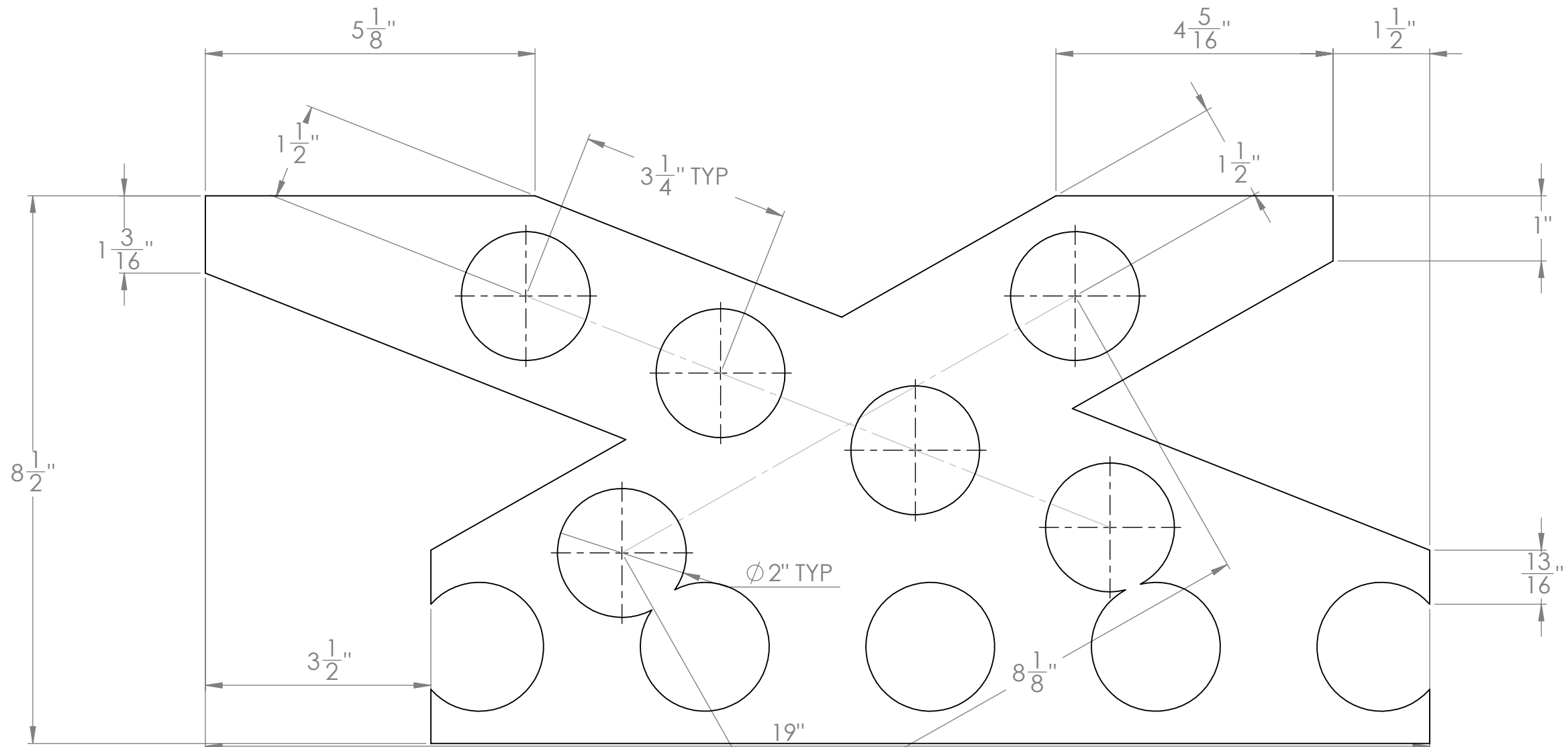

Notes:
 1. Make from 1/2" plywood

REVISIONS				
ZONE	REV.	DESCRIPTION	DATE	APPROVED
	-	Initial Release	1/23/2015	DH

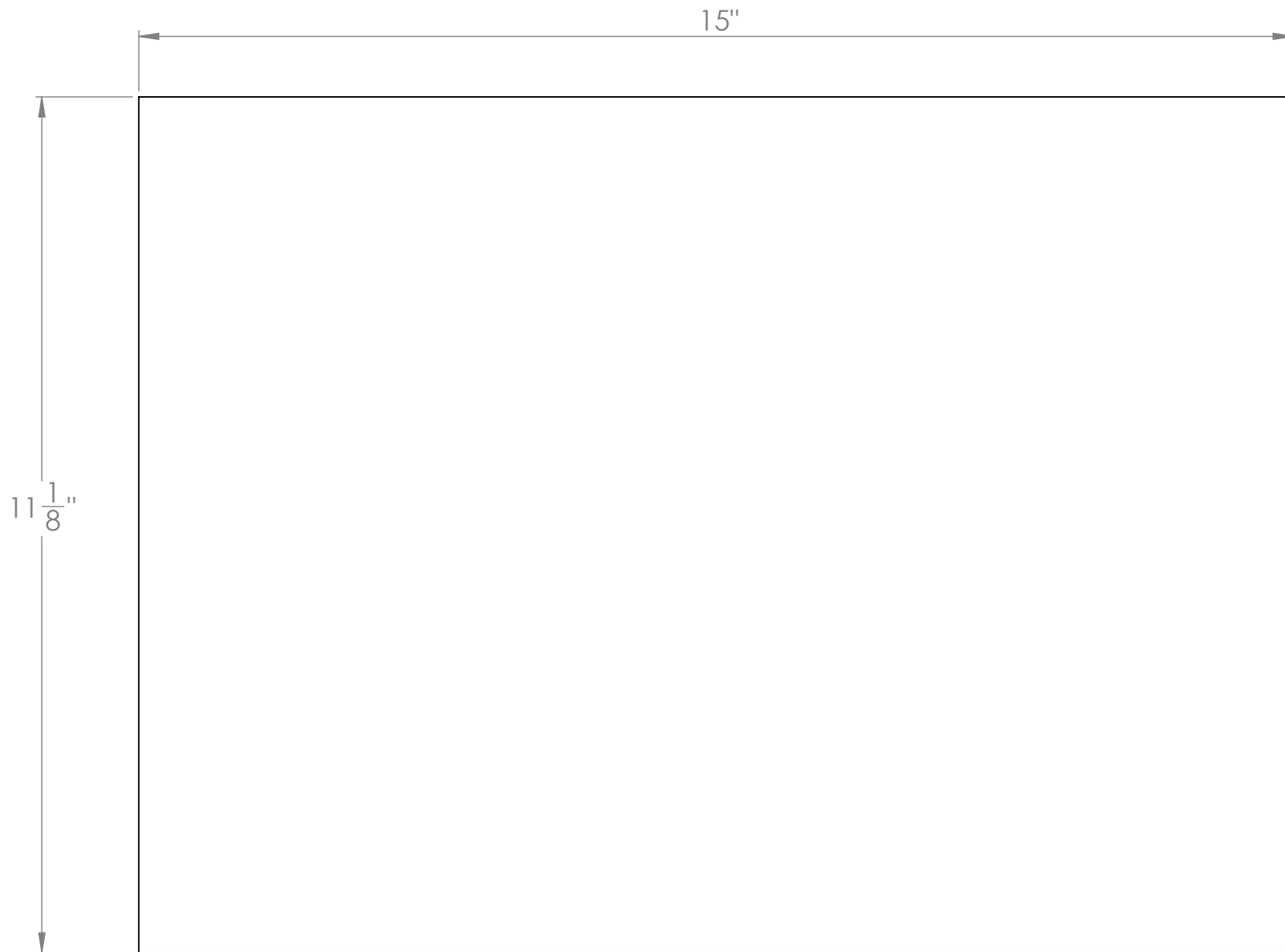

HighlandWolf
 www.highlandwolf.com

Dwg. No. **PCS005**

Sheet: 1 of 1

Printed: 1/26/2015 10:42:16 PM

Cross Plate

Drawn By: **Dana Howard**

INTERPRET PER ASME Y14.5-2009	
TOLERANCES UNLESS OTHERWISE SPECIFIED:	
X.X ± .1	FRACTIONAL:
X.XX ± .01	± 1/16
X.XXX ± .005	
∠ ± .5°	
ALL DIMENSIONS ARE IN INCHES UNLESS OTHERWISE NOTED	

NOTICE TO ALL PERSONS RECEIVING THIS DRAWING
 This drawing is conditionally issued, and neither receipt nor possession thereof confers or transfers any right in, or license to the subject matter of the drawing, design, or the technical information shown thereon.

Notes:
 1. Make from 1/2" Plywood

REVISIONS				
ZONE	REV.	DESCRIPTION	DATE	APPROVED
	-	Initial Release	1/23/2015	DH

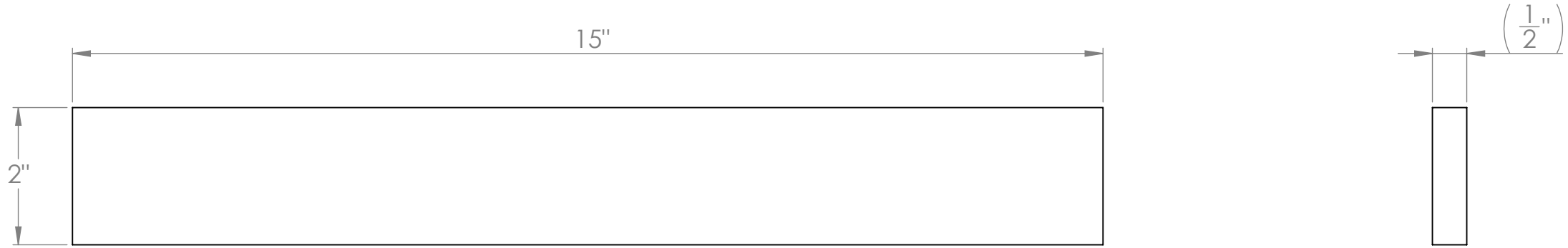

HighlandWolf
 www.highlandwolf.com

Dwg. No. **PCS006**
 Sheet: 1 of 1

Printed: 1/26/2015 10:43:04 PM

Cross Plate Lip

Drawn By: **Dana Howard**

INTERPRET PER ASME Y14.5-2009

TOLERANCES UNLESS OTHERWISE SPECIFIED:

X.X ± .1	FRACTIONAL:
X.XX ± .01	± 1/16
X.XXX ± .005	
∠ ± .5°	

ALL DIMENSIONS ARE IN INCHES UNLESS OTHERWISE NOTED

NOTICE TO ALL PERSONS RECEIVING THIS DRAWING
 This drawing is conditionally issued, and neither receipt nor possession thereof confers or transfers any right in, or license to the subject matter of the drawing, design, or the technical information shown thereon.

REVISIONS				
ZONE	REV.	DESCRIPTION	DATE	APPROVED
	-	Initial Release	1/23/2015	DH

Notes:
1. Make from available wood stock



INTERPRET PER ASME Y14.5-2009	
TOLERANCES UNLESS OTHERWISE SPECIFIED:	
X.X ± .1	FRACTIONAL:
X.XX ± .01	± 1/16
X.XXX ± .005	
∠ ± .5°	
ALL DIMENSIONS ARE IN INCHES UNLESS OTHERWISE NOTED	

NOTICE TO ALL PERSONS RECEIVING THIS DRAWING
This drawing is conditionally issued, and neither receipt nor possession thereof confers or transfers any right in, or license to the subject matter of the drawing, design, or the technical information shown thereon.

Standoff

Drawn By: Dana Howard

Printed: 1/26/2015 10:44:00 PM

Dwg. No. PCS007
Sheet: 1 of 1

HighlandWolf
www.highlandwolf.com

D

C

B

A

D

C

B

A

8

7

6

5

4

3

2

1

8

7

6

5

4

3

2

1